

# Installation Guide

## 32-Channel Commutator

### Installation Schematic

Dimensions are in millimeters (mm)

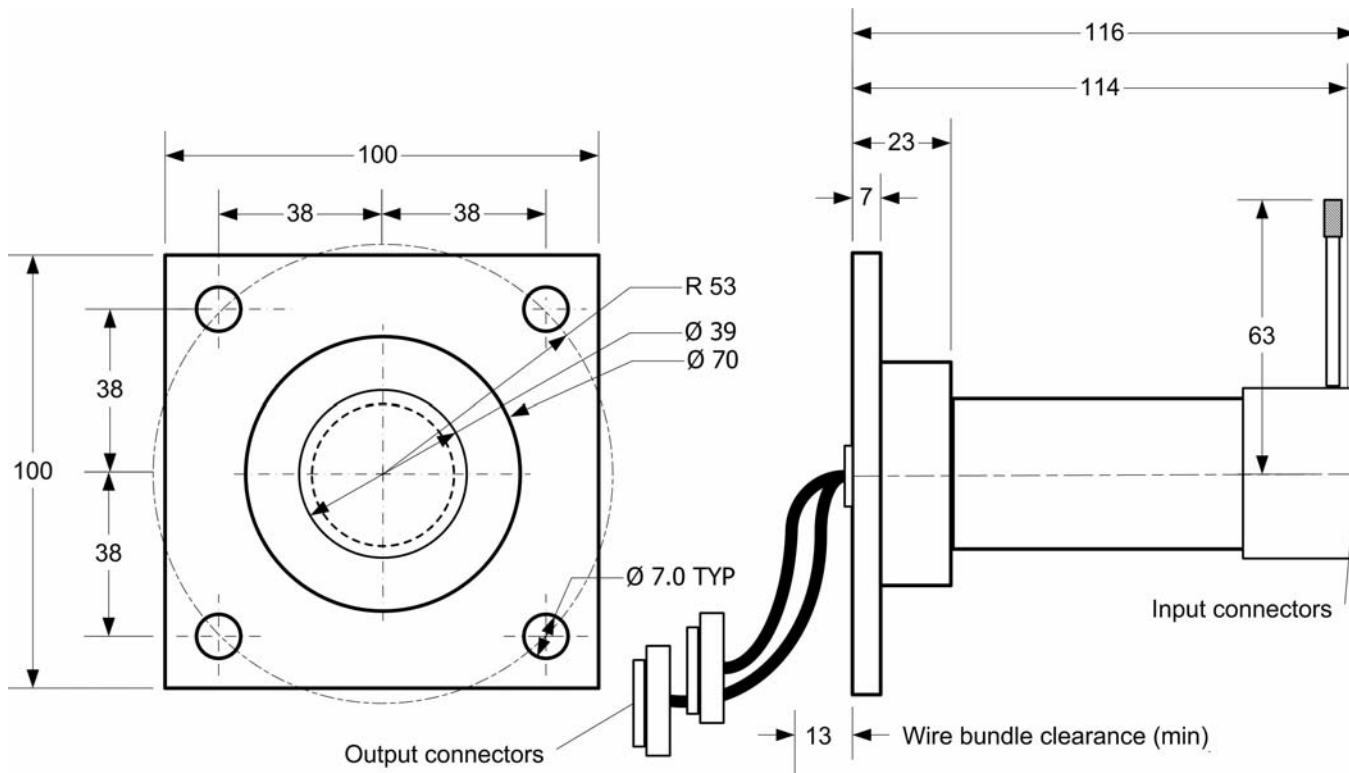

Note: All dimensions were correct at the time of publication. Specifications are subject to change without notice. If you are planning pre-installation work, please contact Plexon to obtain the latest specifications.

**Connector Pin Specifications for Harwin Connectors**

**Male Connectors (Input):**

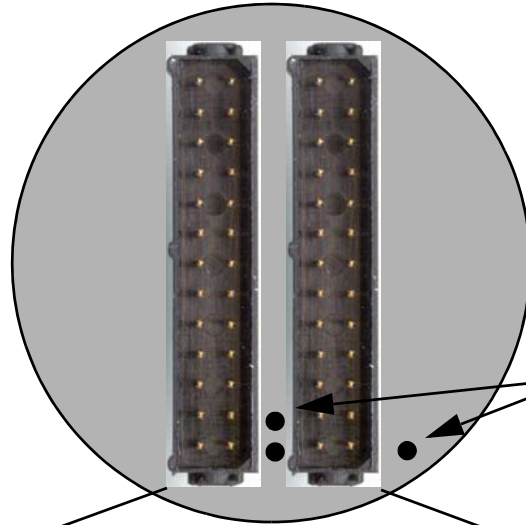

Connector Identifier Dots

- B26 – NC
- B24 – (+V)
- B22 – Channel 32
- B20 – Channel 30
- B18 – Channel 28
- B16 – Channel 26
- B14 – NC
- B12 – Ref B
- B10 – (+V)
- B8 – Channel 24
- B6 – Channel 22
- B4 – Channel 20
- B2 – Channel 18



- B25 – GND
- B23 – (-V)
- B21 – Channel 31
- B19 – Channel 29
- B17 – Channel 27
- B15 – Channel 25
- B13 – NC
- B11 – GND
- B9 – (-V)
- B7 – Channel 23
- B5 – Channel 21
- B3 – Channel 19
- B1 – Channel 17

- A26 – NC
- A24 – (+V)
- A22 – Channel 16
- A20 – Channel 14
- A18 – Channel 12
- A16 – Channel 10
- A14 – NC
- A12 – Ref A
- A10 – (+V)
- A8 – Channel 8
- A6 – Channel 6
- A4 – Channel 4
- A2 – Channel 2



- A25 – GND
- A23 – (-V)
- A21 – Channel 15
- A19 – Channel 13
- A17 – Channel 11
- A15 – Channel 9
- A13 – NC
- A11 – GND
- A9 – (-V)
- A7 – Channel 7
- A5 – Channel 5
- A3 – Channel 3
- A1 – Channel 1

**Female Connectors (Output):**

**Yellow**

- B2 – Channel 18
- B4 – Channel 20
- B6 – Channel 22
- B8 – Channel 24
- B10 – (+V)
- B12 – Ref B
- B14 – NC
- B16 – Channel 26
- B18 – Channel 28
- B20 – Channel 30
- B22 – Channel 32
- B24 – (+V)
- B26 – NC



White Dot

- B1 – Channel 17
- B3 – Channel 19
- B5 – Channel 21
- B7 – Channel 23
- B9 – (-V)
- B11 – GND
- B13 – NC
- B15 – Channel 25
- B17 – Channel 27
- B19 – Channel 29
- B21 – Channel 31
- B23 – (-V)
- B25 – GND

**Red**

- A2 – Channel 2
- A4 – Channel 4
- A6 – Channel 6
- A8 – Channel 8
- A10 – (+V)
- A12 – Ref A
- A14 – NC
- A16 – Channel 10
- A18 – Channel 12
- A20 – Channel 14
- A22 – Channel 16
- A24 – (+V)
- A26 – NC



White Dot

- A1 – Channel 1
- A3 – Channel 3
- A5 – Channel 5
- A7 – Channel 7
- A9 – (-V)
- A11 – GND
- A13 – NC
- A15 – Channel 9
- A17 – Channel 11
- A19 – Channel 13
- A21 – Channel 15
- A23 – (-V)
- A25 – GND