

# Installation Data Sheet

## 16-Channel Commutator

### Installation Schematic

Dimensions are in millimeters (mm).

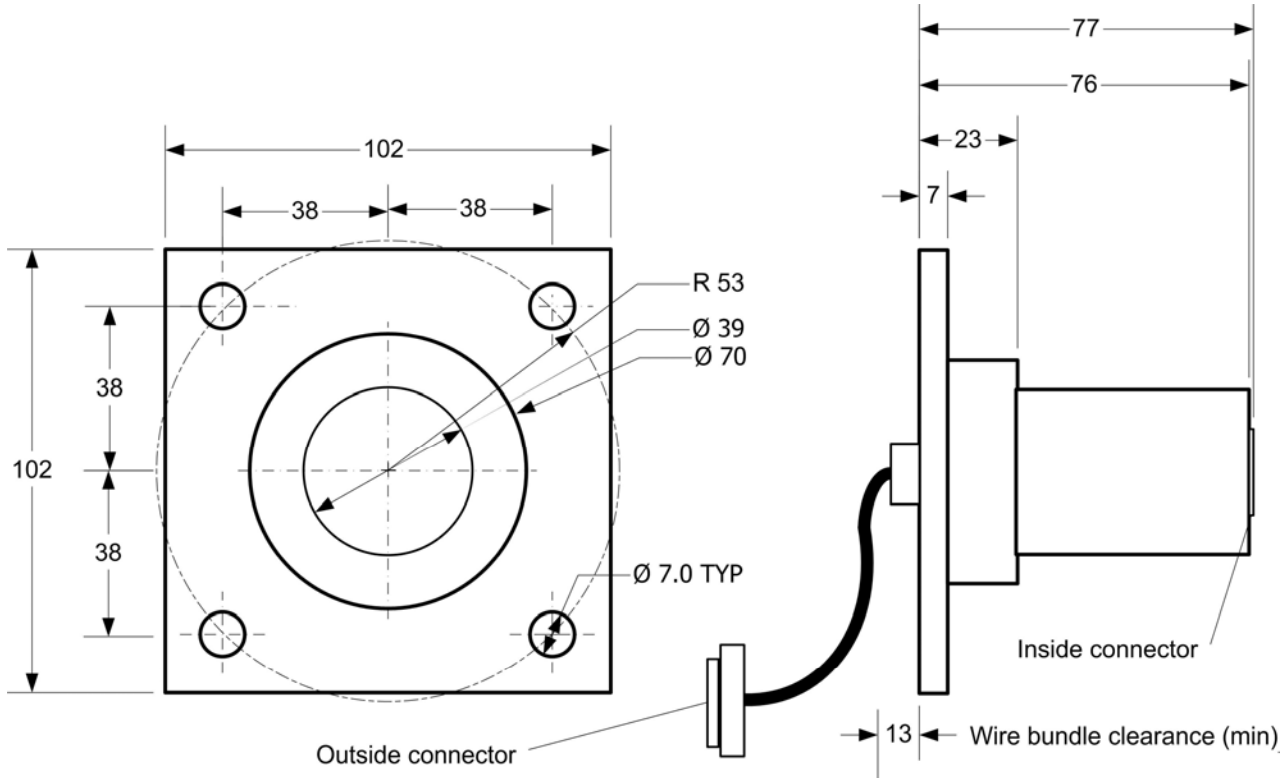

**Note:** All dimensions were correct at the time of publication. Specifications are subject to change without notice. If you are planning pre-installation work, please contact Plexon to obtain the latest specifications.

### Connector pin specifications for Harwin Connectors

Female connector (Outside)

Male connector (Inside)

White triangle

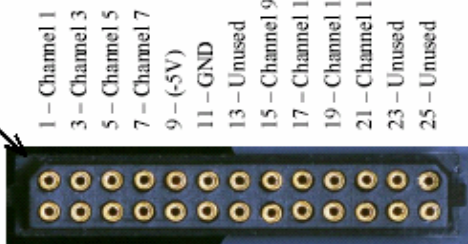

- |                 |                 |
|-----------------|-----------------|
| 1 - Channel 1   | 2 - Channel 2   |
| 3 - Channel 3   | 4 - Channel 4   |
| 5 - Channel 5   | 6 - Channel 6   |
| 7 - Channel 7   | 8 - Channel 8   |
| 9 - (-5V)       | 10 - (+5V)      |
| 11 - GND        | 12 - Reference  |
| 13 - Unused     | 14 - Unused     |
| 15 - Channel 9  | 16 - Channel 10 |
| 17 - Channel 11 | 18 - Channel 12 |
| 19 - Channel 13 | 20 - Channel 14 |
| 21 - Channel 15 | 22 - Channel 16 |
| 23 - Unused     | 24 - Unused     |
| 25 - Unused     | 26 - Unused     |

Connector locator dots →

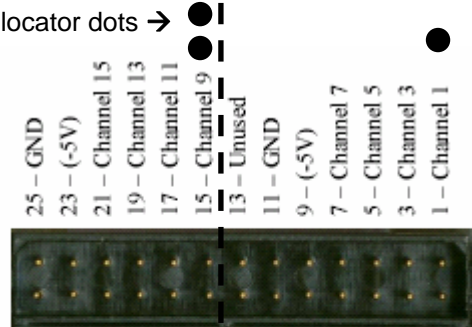

- |                 |                 |
|-----------------|-----------------|
| 25 - GND        | 26 - Unused     |
| 23 - (-5V)      | 24 - (+5V)      |
| 21 - Channel 15 | 22 - Channel 16 |
| 19 - Channel 13 | 20 - Channel 14 |
| 17 - Channel 11 | 18 - Channel 12 |
| 15 - Channel 9  | 16 - Channel 10 |
| 13 - Unused     | 14 - Unused     |
| 11 - GND        | 12 - Reference  |
| 9 - (-5V)       | 10 - (+5V)      |
| 7 - Channel 7   | 8 - Channel 8   |
| 5 - Channel 5   | 6 - Channel 6   |
| 3 - Channel 3   | 4 - Channel 4   |
| 1 - Channel 1   | 2 - Channel 2   |